

PROJECT TEAM

ARCHITECT
 GRAPHITE NINE DESIGN, PLLC
 AUSTIN, TEXAS
 850.723.9566
 CONTACT: ANDY WEBRE, AIA

STRUCTURAL ENGINEER
 TBD

CIVIL ENGINEER
 TBD

LIVING HOPE BIBLE CHURCH

3075 OLD BLACK COLONY RD
 BUDA, TX 78610

FEASIBILITY

Project No: 2302.00

ISSUE DATE: 05/26/2026



VICINITY MAP



SHEET INDEX:

NUMBER	NAME
00 GENERAL	
G000.2	COVER SHEET - PHASE 2
G001	PROJECT INFORMATION
03 EXISTING CONDITIONS	
EC001	OVERALL EXISTING SITE PLAN
03 LIFE SAFETY	
LS101.2	LIFE SAFETY
04 ARCHITECTURAL	
A001	CONCEPT SITE PLAN
A101.2	FOUNDATION PLAN
A102.2	LEVEL 1 PLAN
A103.2	LEVEL 2 PLAN
A104.2	ROOF PLAN
A201.2	EXTERIOR ELEVATIONS
A202.2	EXTERIOR ELEVATIONS
A301.2	LONGITUDINAL SECTIONS
A302.2	CROSS SECTIONS
A501.2	CONCEPT WALL SECTIONS
A1001.2	3D VIEWS - STEEL FRAME

KEY PLAN

STAMP

NOT FOR CONSTRUCTION
 These documents are incomplete, and are released for interim review only and are not intended for regulatory approval, permits, or construction purposes.

ISSUES

SHEET INFORMATION

COVER SHEET - PHASE 2

G000.2

GraphitNine holds all rights of copyright to these drawings. Any reproductions, alterations, modifications, usage or incorporation into other documents may not occur without the prior written permission of GraphitNine. © 2026 Graphite Nine Design, PLLC

THE LINES SHOWN ABOVE ARE EXACTLY ONE SHEET SIZE ORIGINAL PAPER SIZE

D

THE SQUARES ABOVE ARE COLOR, WITH A LETTER, IF PRINTED CORRECTLY

C

B

A

5/27/2026 10:25:04 AM

THE LINE SHOWN ABOVE IS EXACTLY ONE SHEET ABOVE THE ORIGINAL PAGE SIZE

D

THE SQUARES ABOVE ARE COLOR, WITH THE CORRESPONDING LETTER, IF PRINTED CORRECTLY

C

B

A

5/27/2026 10:23:09 AM

CODE (KEY)- OCCUPANCY- AREA OCCUPANT LOAD FACTORS				
KEY NAME	FUNCTION	CLASS	LOAD FACTOR	G OR N
(IBC2024) ACCESSORY STORAGE AREAS	ACC. STORAGE	B	300.00 SF	G
(IBC2024) AGRICULTURAL BUILDING		U	300.00 SF	G
(IBC2024) AIRCRAFT HANGARS		S-1	500.00 SF	G
(IBC2024) AIRPORT TERMINAL - BAGGAGE CLAIM		A-3	20.00 SF	G
(IBC2024) AIRPORT TERMINAL - BAGGAGE HANDLING		A-3	300.00 SF	G
(IBC2024) AIRPORT TERMINAL - CONCOURSE		A-3	100.00 SF	G
(IBC2024) AIRPORT TERMINAL - WAITING AREAS		A-3	15.00 SF	N
(IBC2024) ASSEMBLY- EXHIBIT GALLERY AND MUSEUM	ASSEMBLY - GALLERY	A-1	0.00 SF	*
(IBC2024) ASSEMBLY- FIXED SEATS	ASSEMBLY - FIXED	A-1	0.00 SF	*
(IBC2024) ASSEMBLY- GAMING FLOORS	ASSEMBLY - GAMING	A-2	11.00 SF	G
(IBC2024) ASSEMBLY- NO FIXED SEATS- CONCENTRATED	ASSEMBLY - CONC.	A-3	7.00 SF	N
(IBC2024) ASSEMBLY- NO FIXED SEATS- CONCENTRATED (CHAIRS ONLY)	ASSEMBLY - CONC. CHAIRS	A-2	7.00 SF	N
(IBC2024) ASSEMBLY- NO FIXED SEATS- STANDING SPACE	ASSEMBLY - STANDING	A-3	5.00 SF	N
(IBC2024) ASSEMBLY- NO FIXED SEATS- UNCONCENTRATED	ASSEMBLY - UNCONC.	A-2	15.00 SF	N
(IBC2024) BOWLING CENTERS	BOWLING	A-3	7.00 SF	N
(IBC2024) BUSINESS AREAS	BUSINESS	B	150.00 SF	G
(IBC2024) BUSINESS AREAS- CONCENTRATED BUSINESS USE AREAS	BUSINESS - CONC.	B		*
(IBC2024) COURTRROOMS- OTHER THAN FIXED SEATING	COURTROOM	A-3	40.00 SF	N
(IBC2024) DAY CARE	DAY CARE	I-4	35.00 SF	N
(IBC2024) DORMITORIES	DORMITORY	R-2	50.00 SF	G
(IBC2024) EDUCATIONAL- CLASSROOM AREA	EDU - CLASSROOM	E	20.00 SF	N
(IBC2024) EDUCATIONAL- SHOPS AND OTHER VOCATIONAL ROOM AREAS	EDU - OTHER	E	50.00 SF	N
(IBC2024) EXERCISE ROOMS	EXERCISE ROOM	A-3	50.00 SF	G
(IBC2024) GROUP H-5 FABRICATION AND MANUFACTURING AREAS		H-5	200.00 SF	G
(IBC2024) INDUSTRIAL AREAS	INDUSTRIAL	I	100.00 SF	G
(IBC2024) INSTITUTIONAL AREAS- INPATIENT TREATMENT AREAS	INPATIENT TREATMENT	I-2	240.00 SF	G
(IBC2024) INSTITUTIONAL AREAS- OUTPATIENT AREAS	OUTPATIENT	B	100.00 SF	G
(IBC2024) INSTITUTIONAL AREAS- SLEEPING AREAS	SLEEPING AREA	I-2	120.00 SF	G
(IBC2024) KITCHENS- COMMERCIAL	KITCHEN	B	200.00 SF	G
(IBC2024) LIBRARY- READING ROOMS	LIBRARY - READING	A-3	50.00 SF	N
(IBC2024) LIBRARY- STACK AREA	LIBRARY - STACKS	A-3	100.00 SF	G
(IBC2024) LOCKER ROOMS	LOCKER ROOM	A-3	50.00 SF	G
(IBC2024) MECHANICAL EQUIPMENT ROOM	MECH. ROOM	B	300.00 SF	G
(IBC2024) MERCANTILE	MERCANTILE	M	60.00 SF	G
(IBC2024) MERCANTILE- STORAGE, STOCK, SHIPPING AREAS	MERCANTILE - BOH	M	300.00 SF	G
(IBC2024) PARKING GARAGE	PARKING	S-2	200.00 SF	G
(IBC2024) RESIDENTIAL	RESIDENTIAL	R-2	200.00 SF	G
(IBC2024) SKATING AND SWIMMING- DECK AREA	SWIMMING - DECK	A-4	15.00 SF	G
(IBC2024) SKATING AND SWIMMING- RINK AND POOL AREA	SWIMMING - POOL	A-4	50.00 SF	G
(IBC2024) STAGES AND PLATFORMS	STAGE	A-1	15.00 SF	N
(IBC2024) WAREHOUSES	WAREHOUSE		500.00 SF	G
SHELL	SHELL	TBD		G

2 LIFE SAFETY AREAS - LVL 2
1/8" = 1'-0"

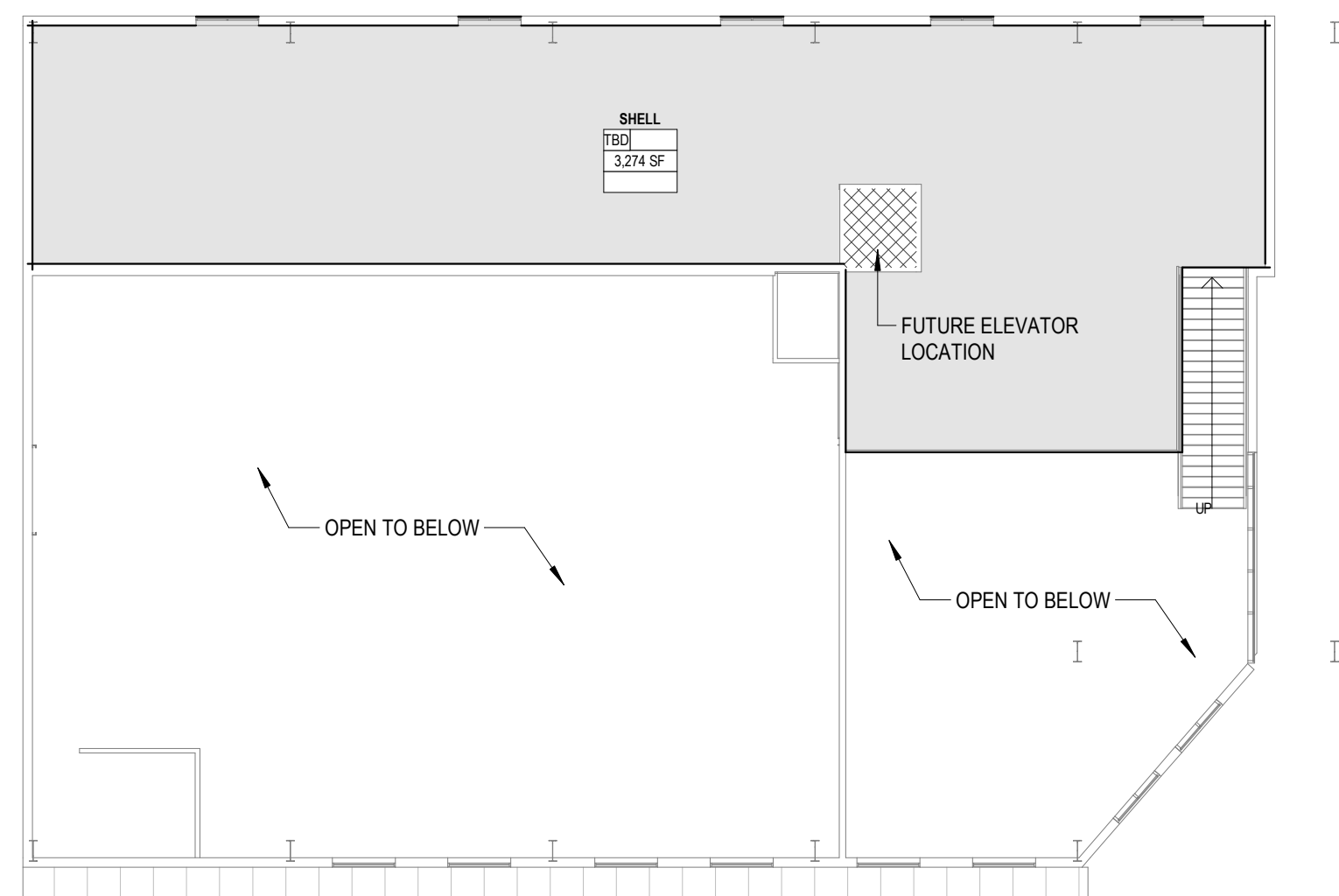

4

PLUMBING FIXTURES REQUIRED- LEVEL 1										
NUMBER	NAME	PLUMBING OCCUPANCY KEY	AREA PER OCCUPANT	AREA	OCCUPANTS	WATER CLOSETS		LAVS		CURRENT REV
						MALE	FEMALE	MALE	FEMALE	
LVL1	EDU - OTHER	(none)	0.00 SF	952.25 SF						
	PRE-FUNCTION	(none)	0.00 SF	1,696.39 SF						
	STORAGE	(none)	0.00 SF	86.97 SF						
	BATHROOMS	(none)	0.00 SF	119.17 SF						
	BATHROOMS	(none)	0.00 SF	587.38 SF						
	STORAGE	(none)	0.00 SF	208.53 SF						
				3,732.49 SF	0	0	0	0	0	0
	ASSEMBLY - CONCENTRATED	A-3: PLACES OF WORSHIP AND OTHER RELIGIOUS SERVICES	7.00 SF	2,971.50 SF	425	1.416667	2.833333	1.0625	1.0625	0.425
				2,971.50 SF	425	1.416667	2.833333	1.0625	1.0625	0.425
	AV BOOTH	B: BUSINESSES, PROFESSIONAL SERVICES, MERCHANDISING, OFFICE BUILDINGS, LIGHT INDUSTRIAL	150.00 SF	152.66 SF	2	0.04	0.04	0.025	0.025	0.025
				152.66 SF	2	0.04	0.04	0.025	0.025	0.025
	EDU - CLASSROOMS	E: EDUCATIONAL FACILITIES	20.00 SF	500.89 SF	26	0.26	0.26	0.26	0.26	0.26
	EDU - CLASSROOMS	E: EDUCATIONAL FACILITIES	20.00 SF	568.95 SF	28	0.28	0.28	0.28	0.28	0.28
	EDU - CLASSROOMS	E: EDUCATIONAL FACILITIES	20.00 SF	247.74 SF	13	0.13	0.13	0.13	0.13	0.13
				1,307.58 SF	67	0.67	0.67	0.67	0.67	0.67
	STAGE / PLATFORM	A-3: PLACES OF WORSHIP AND OTHER RELIGIOUS SERVICES	15.00 SF	890.46 SF	60	0.2	0.4	0.15	0.15	0.06
				890.46 SF	60	0.2	0.4	0.15	0.15	0.06
LVL 2	SHELL	(none)		3,273.76 SF						
				3,273.76 SF						
				12,328.45 SF	554	2.326667	3.943333	1.9075	1.9075	1.18

OCCUPANCY CALCULATIONS									
NAME	CLASS	FUNCTION	AREA	AREA FUNCTION (OLF)	AREA PER OCCUPANT	OCCUPANTS_CALCULATED	OCCUPANTS_MANUAL	Comments	
LVL1	EDU - CLASSROOMS	E	EDU - CLASSROOM	500.89 SF	(IBC2024) EDUCATIONAL- CLASSROOM AREA	20.00 SF	26		
	EDU - CLASSROOMS	E	EDU - CLASSROOM	568.95 SF	(IBC2024) EDUCATIONAL- CLASSROOM AREA	20.00 SF	28		
	EDU - OTHER		EDU - OTHER	952.25 SF	(none)	0.00 SF			
	PRE-FUNCTION	A-3	ASSEMBLY - STANDING	1,696.39 SF	(none)	0.00 SF			
	AV BOOTH	B	BUSINESS	152.66 SF	(IBC2024) BUSINESS AREAS	150.00 SF	2		
	ASSEMBLY - CONCENTRATED	A-3	ASSEMBLY - CONC.	2,971.50 SF	(IBC2024) ASSEMBLY- NO FIXED SEATS- CONCENTRATED	7.00 SF	425		
	STAGE / PLATFORM	A-1	STAGE	890.46 SF	(IBC2024) STAGES AND PLATFORMS	15.00 SF	60		
	EDU - CLASSROOMS	E	EDU - CLASSROOM	247.74 SF	(IBC2024) EDUCATIONAL- CLASSROOM AREA	20.00 SF	13		
	STORAGE			86.97 SF	(none)	0.00 SF			
	STORAGE			119.17 SF	(none)	0.00 SF			
	BATHROOMS			81.81 SF	(none)	0.00 SF			
	BATHROOMS			587.38 SF	(none)	0.00 SF			
	STORAGE			208.53 SF	(none)	0.00 SF			
				9,054.69 SF			554	0	
LVL 2	SHELL	TBD	SHELL	3,273.76 SF	SHELL			0	
				3,273.76 SF				0	

1 LIFE SAFETY AREAS - LVL 1
1/8" = 1'-0"



2

OCCUPANCY TYPES

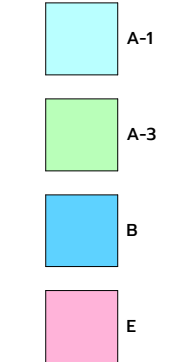

NOT FOR CONSTRUCTION
These documents are incomplete, and are released for interim review only and are not intended for regulatory approval, permit, or construction purposes.

KEY PLAN

STAMP

ISSUES

SHEET INFORMATION

LIFE SAFETY

LS101.2

5

1

3

